

- 7101    Obsazení kazety počítače náprav FAdC
- 7102    FAdC – napájení
- 7103    FAdC – komunikace
- 7104    FAdC – zapojení čidel PN
- 7105    FAdC – kolejové úseky
- 7106    FAdC – PZS KR1 výstupy
- 7107    FAdC – PZS KR1 vstupy
- 7108    FAdC – PZS KR1 vstupy
- 7109    FAdC – směrové výstupy

23.8.2022

|   |                           |                   |                           |   |
|---|---------------------------|-------------------|---------------------------|---|
| Zakázkové číslo:<br>21-049-40-211   |                           | Jméno<br>Navrátil | Podpis<br><i>Navrátil</i> | <br>Pracoviště 211 – Ostrava |
| Datum:<br>8.2022  | Ved. pracoviště<br>Navrhl | Navrátil          | <i>Navrátil</i>           |   |
| Stupeň dokumentace: RDS   | Kontroloval               | Navrátil          | <i>Navrátil</i>           |   |
| Oprava PZS v úseku Rožďalovice – Nemyčeves<br>PS 01-01-34 PZS v km 28,925 (P4625) |                           |                   |                           | 7100  |
| Počítač náprav  |                           |                   |                           |   |

Panel počítače náprav FAdC  
čelní pohled na kazetu BGT07-84TE

| BP-PWR101-4 |  |          |  |         |  |    |  |      |  | 24 TE     |  | BP-EXB101-4 |  |                |  |                |  |      |  |       |  | 28 TE |  |
|-------------|--|----------|--|---------|--|----|--|------|--|-----------|--|-------------|--|----------------|--|----------------|--|------|--|-------|--|-------|--|
| PSC1        |  | COM1     |  | BKP84   |  |    |  |      |  | BKP85     |  | EXB1        |  | EXB2           |  | EXB3           |  |      |  |       |  |       |  |
|             |  | ID101    |  | ID001   |  |    |  |      |  | ID003     |  | A:T2BA-K0   |  | IN (ID003)     |  | IN (ID003)     |  |      |  |       |  |       |  |
| Master      |  | A1: -    |  |         |  | KP |  | KP   |  | T2BA-K0   |  | B:T3-4BA-K0 |  | 1: BK2-KZ      |  | 1: BK2-BA      |  | KP   |  | KP    |  |       |  |
|             |  | A2: -    |  |         |  |    |  |      |  | T3-4BA-K0 |  |             |  | 2: BK2-NS      |  | 2: BK2-BV      |  |      |  |       |  |       |  |
|             |  | Eth. 1:  |  | Eth. 2: |  |    |  |      |  |           |  |             |  | 3: BK2-CS      |  | 3: BK2-PR      |  |      |  |       |  |       |  |
|             |  | Holistic |  | Serial  |  |    |  | 4 TE |  | 4 TE      |  |             |  | OUT(Kopi dino) |  | OUT(Kopi dino) |  | 6 TE |  | 32 TE |  |       |  |
|             |  | Eth. 1   |  | Eth. 2  |  |    |  |      |  |           |  |             |  | 1: NOP         |  | 1: -           |  |      |  |       |  |       |  |
|             |  | Eth. 2   |  | Eth. 1  |  |    |  |      |  |           |  |             |  | 2: DK          |  | 2: -           |  |      |  |       |  |       |  |
|             |  | COM      |  | AdC101  |  |    |  |      |  |           |  |             |  | 3: -           |  | 3: -           |  |      |  |       |  |       |  |
| PSC101      |  | AEB101   |  |         |  |    |  |      |  | AEB101    |  | IO-EXB101   |  | IO-EXB101      |  | IO-EXB101      |  |      |  |       |  |       |  |
| 01          |  | 02       |  | 03      |  | 04 |  | 05   |  | 06        |  | 07          |  | 08             |  | 09             |  |      |  |       |  |       |  |

1301\_

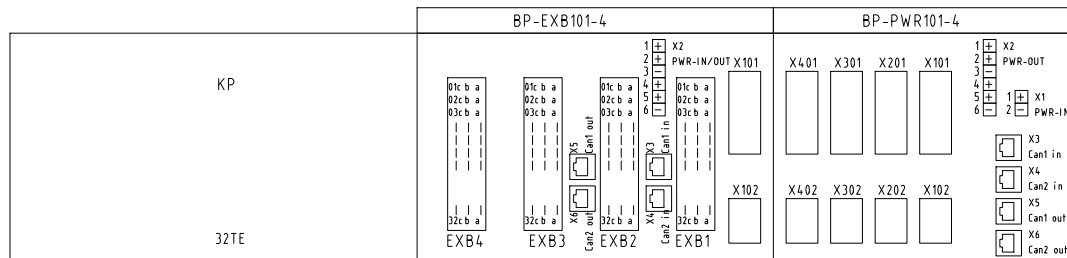

Zadní pohled na kazetu BGT07-84TE

23.8.2022

Oprava PZS v úseku Rožďalovice – Nemyčeves

PS 01-01-34 PZS v km 28,925 (P4625)

Obsazení kazety počítače náprav FAdC

7101

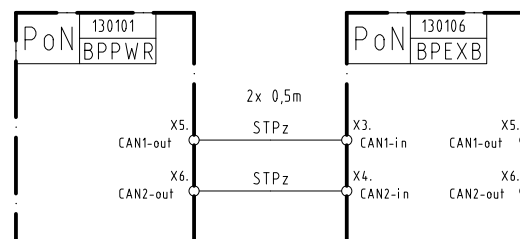
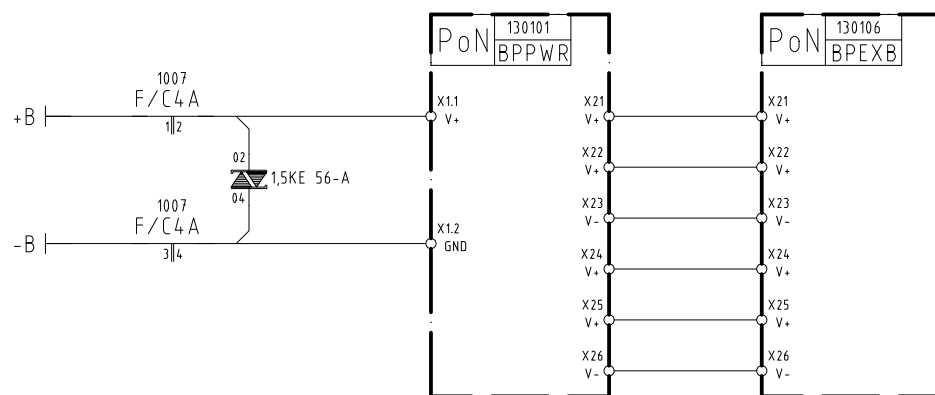

23.8.2022

Oprava PZS v úseku Roždálovice – Nemyčevy

PS 01–01–34 PZS v km 28,925 (P4625)

FAdC – napájení

7102

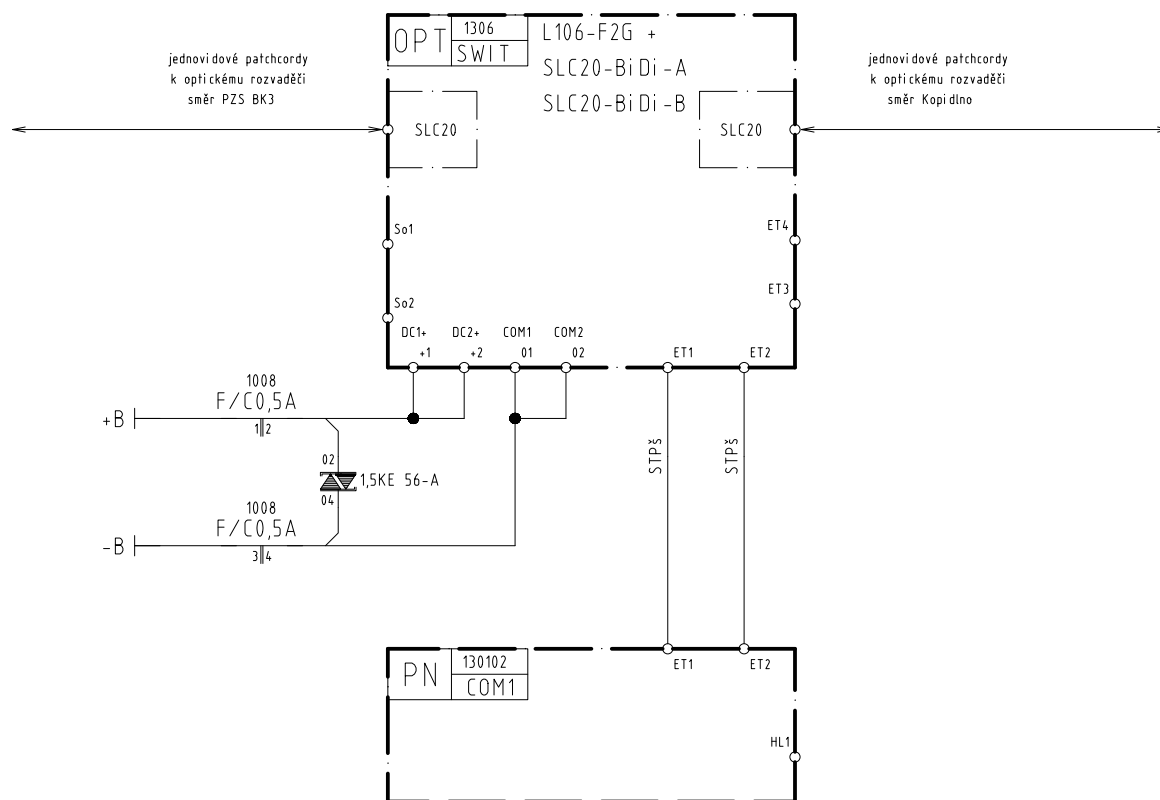

23.8.2022

Oprava PZS v úseku Roždálovice - Nemyčevy

PS 01-01-34 PZS v km 28,925 (P4625)

FAdC - komunikace

7103

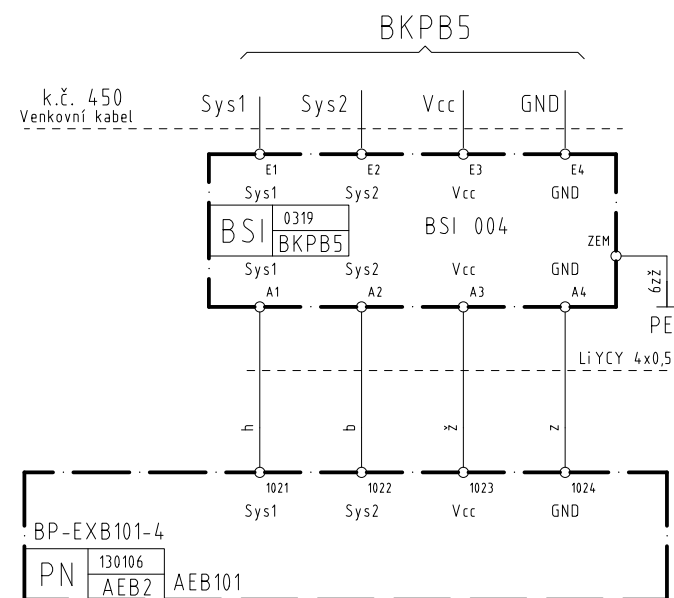
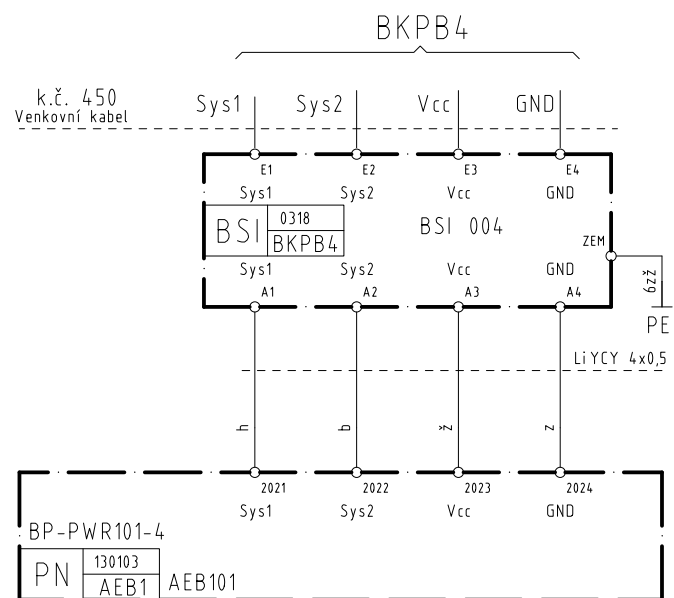

23.8.2022

Oprava PZS v úseku Roždálovice – Nemyčevy

PS 01–01–34 PZS v km 28,925 (P4625)

FAdC – zapojení čidel PN

7104

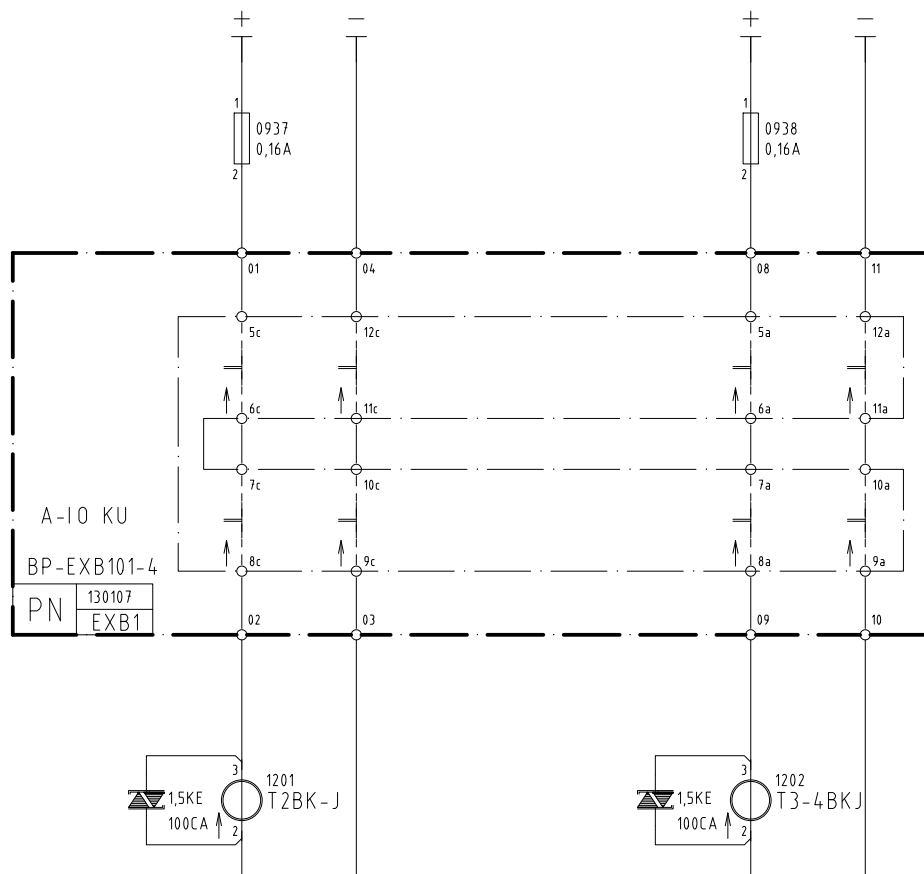

23.8.2022

Oprava PZS v úseku Roždálovice – Nemyčeves

PS 01–01–34 PZS v km 28,925 (P4625)

FAdC – kolejové úseky

7105

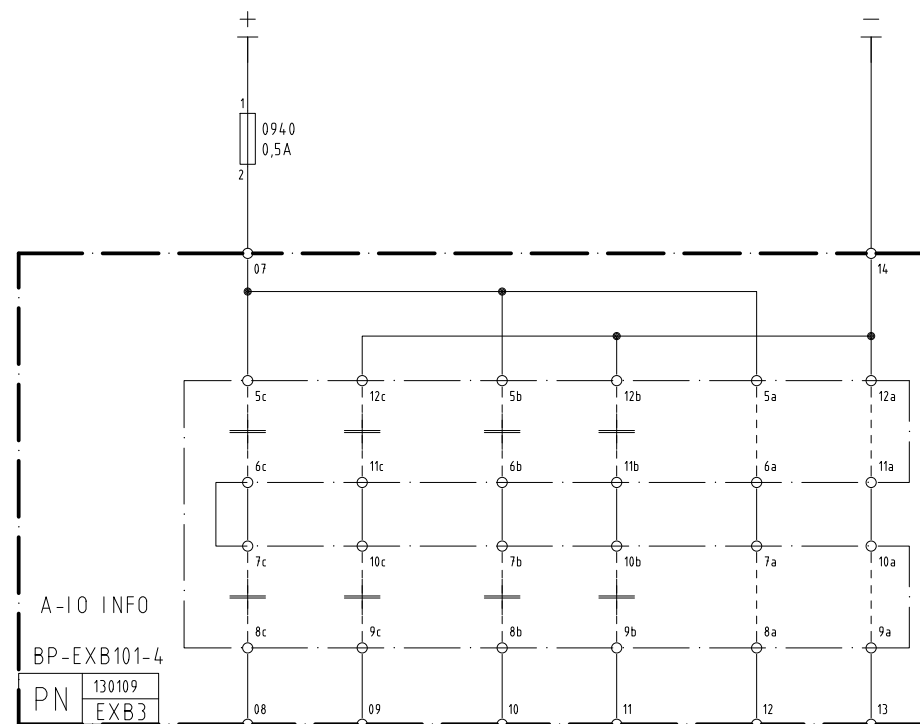
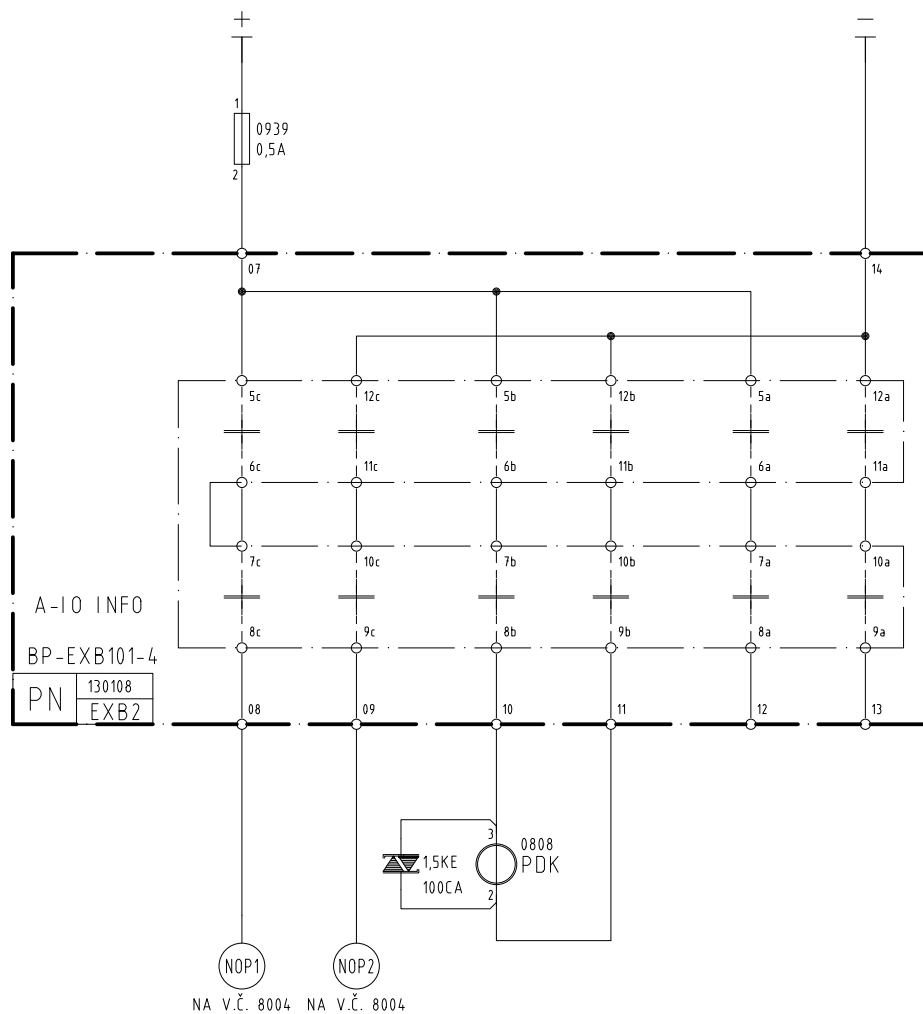

23.8.2022

Oprava PZS v úseku Roždálovice – Nemyčevy

PS 01-01-34 PZS v km 28,925 (P4625)

FAdC – PZS BK2 výstupy

7106

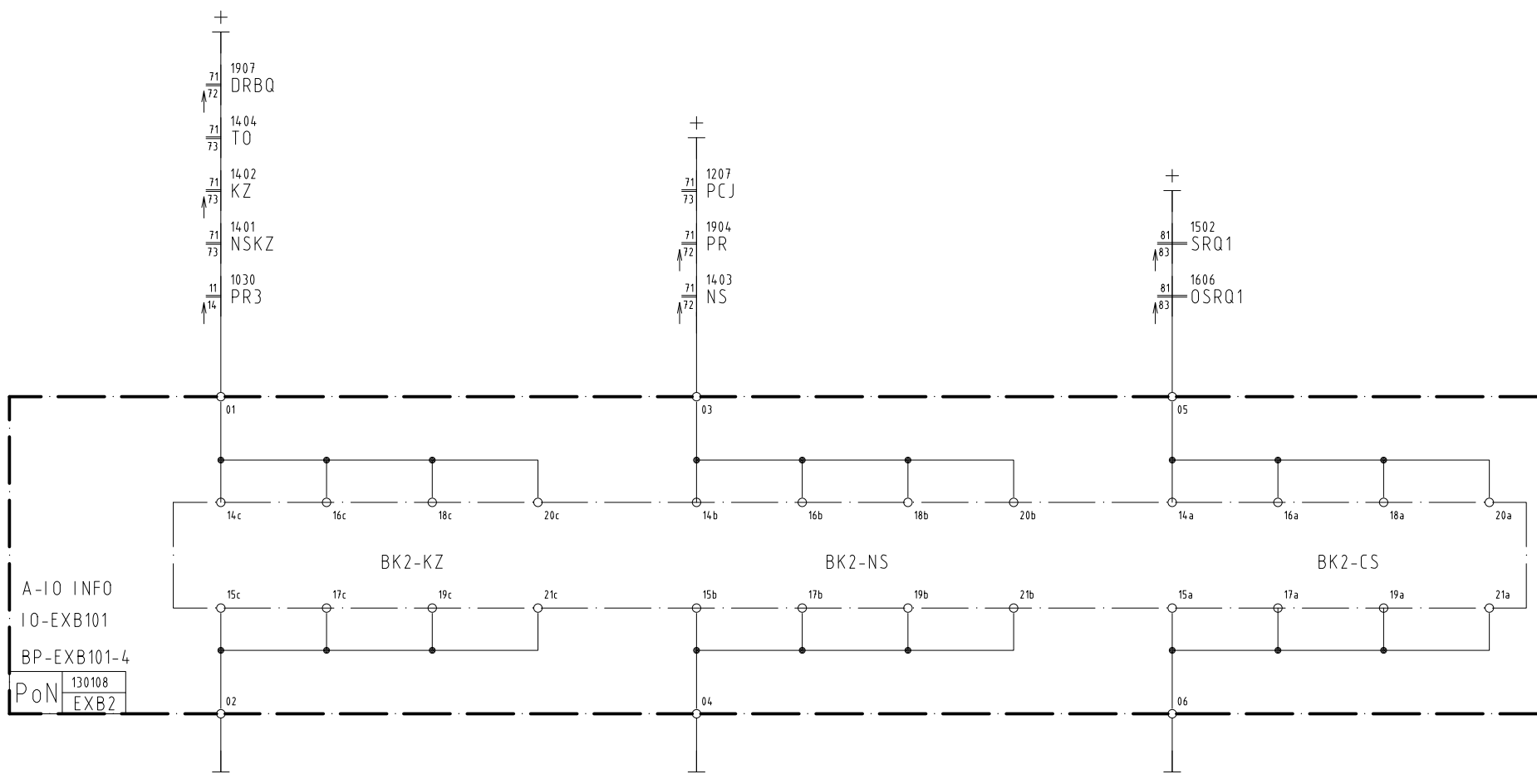

23.8.2022

Oprava PZS v úseku Roždálovice – Nemyčevce

PS 01-01-34 PZS v km 28,925 (P4625)

FAdC – PZS BK2 vstupy

7107



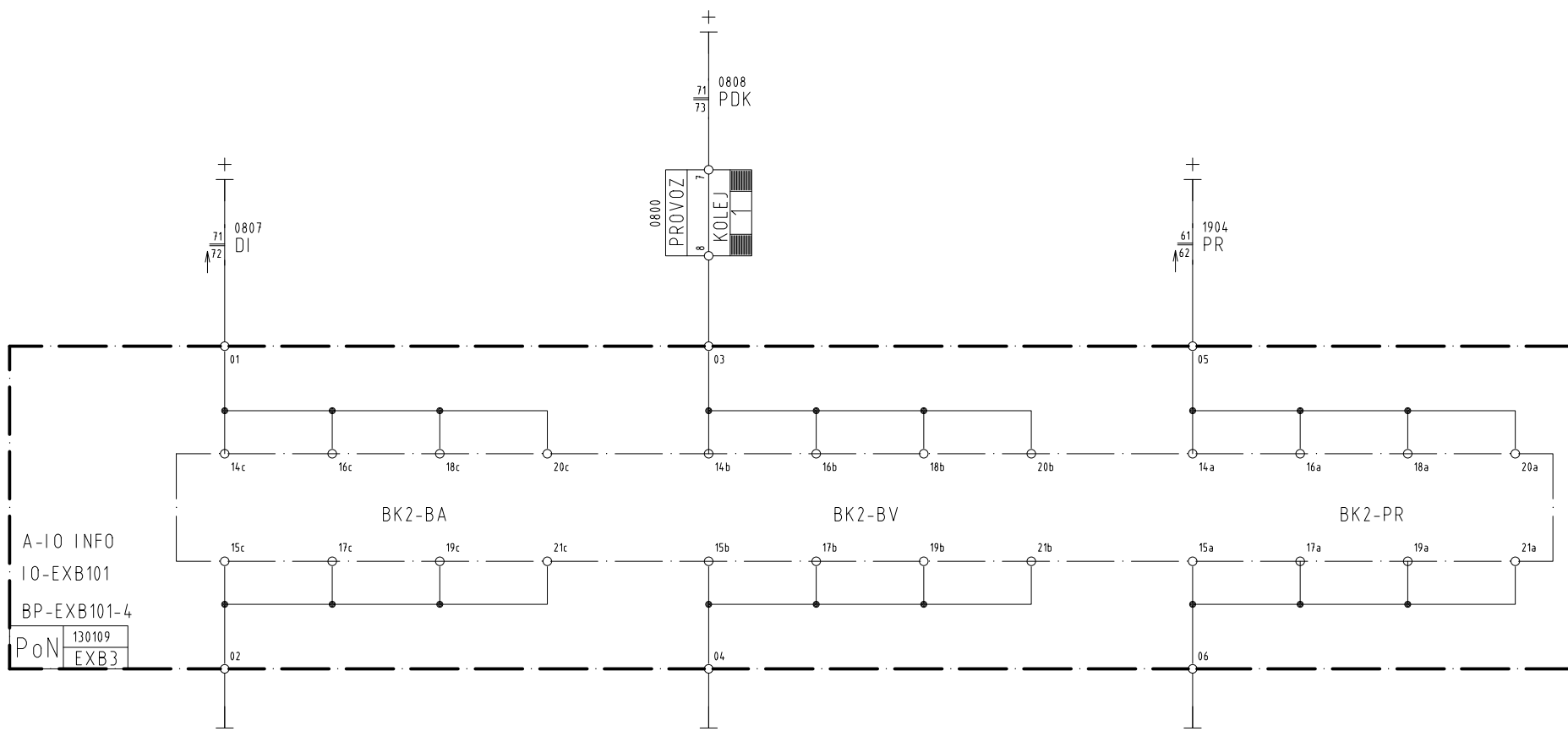

A-IO INFO  
IO-EXB101  
BP-EXB101-4  
P0N 130109  
EXB3

23.8.2022

Oprava PZS v úseku Roždálovice – Nemyčevy

PS 01-01-34 PZS v km 28,925 (P4625)

FAdC – PZS BK2 vstupy

7108

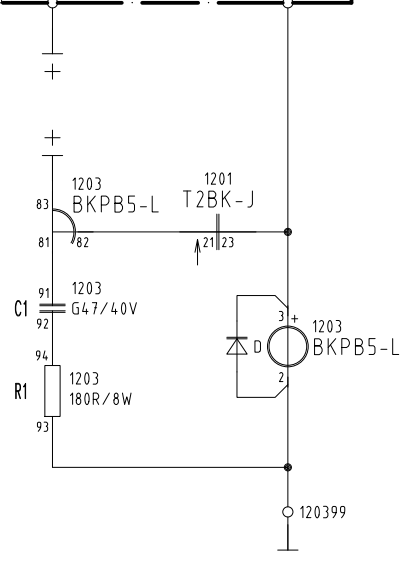
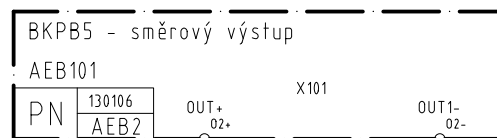
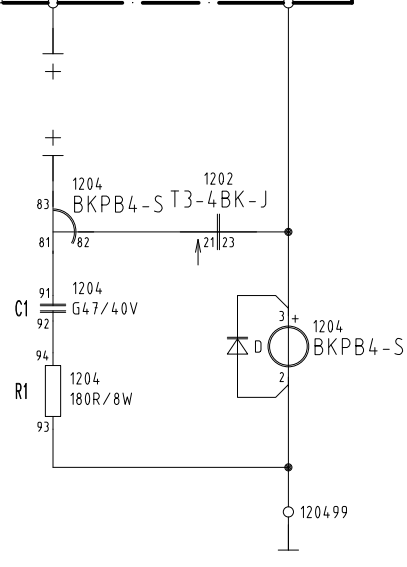
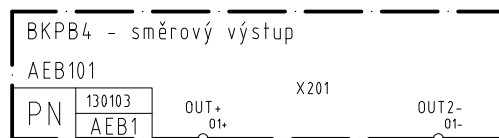

23.8.2022

Oprava PZS v úseku Roždálovice - Nemyčeves

PS 01-01-34 PZS v km 28,925 (P4625)

FAdC - směrové výstupy

7109