

The diagram illustrates the power supply architecture for the RACK_01_01 server rack. It features a main power distribution unit (Rozvaděč R-NN) at the top, which is connected to a main power bus (2x Fa16/B/1). The power is then distributed to two separate power distribution panels (Zásuvkový panel) via NYY-J 3x2.5 cables. One panel is connected to a UPS 230V AC, which is then connected to a switch (L2 switch 24p, 4xSFP).

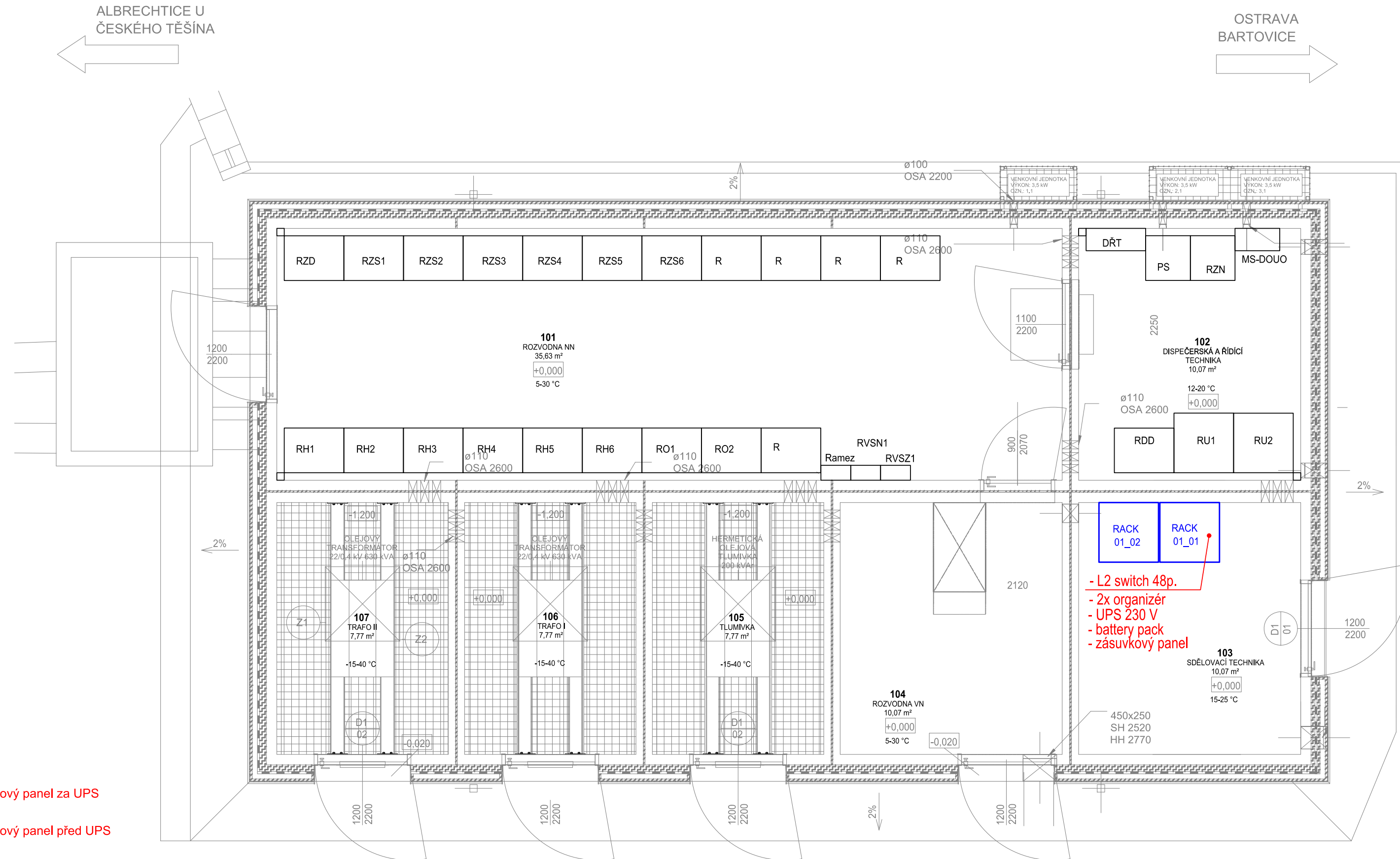
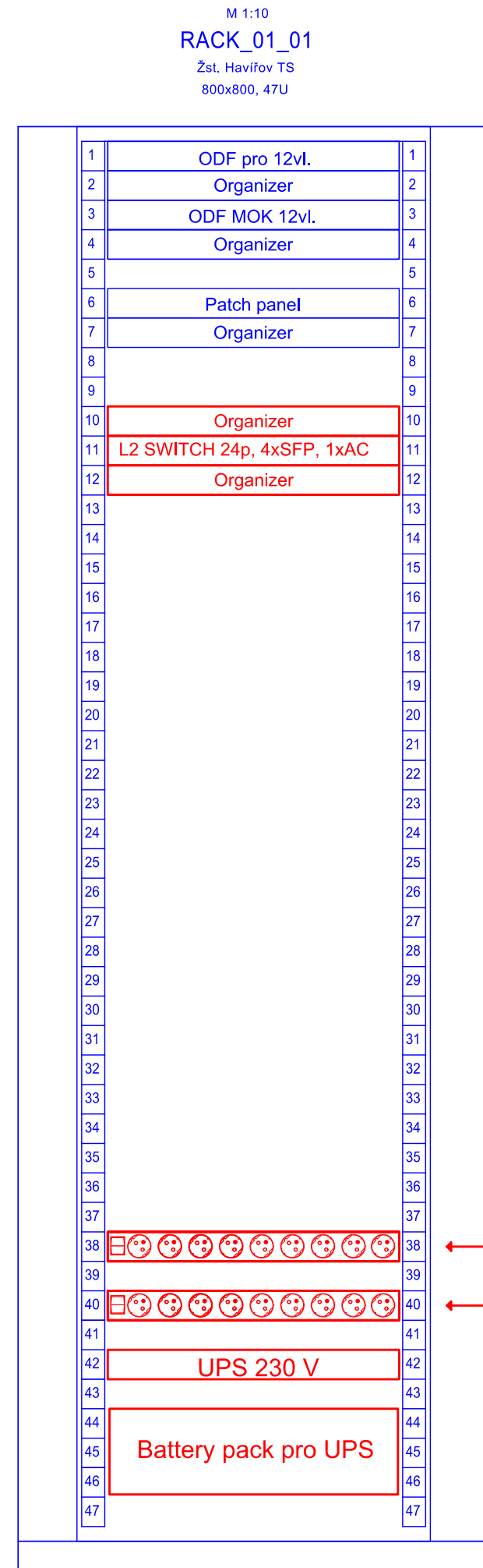

— Zařízení a propojení obsažená v tomto PS
— Zařízení a propojení obsažená v ostatních PS